

# Product solutions for Long-Term Care, Skilled Nursing, Assisted Living and Other LTC environments



## One Facility: Many Areas, Many Surfaces, Many Infection Control Risks

Long-term care residents are at high risk for developing Healthcare Associated Infections (HAIs). Infection prevention and control programs in long-term care facilities can help prevent the spread of infection to vulnerable residents. Proper cleaning and disinfecting programs depend on identifying the challenges and risks within a facility and responding with the most appropriate products.

### High Risk Areas/Occasions

Isolation Rooms, Resident Gathering Spaces (activity room, dining room, lounging areas)

A recent study found that 50% of long-term residents were colonized with MDROs and environmental MDRO contamination was found in 74% of resident rooms and 93% of common areas.<sup>1</sup>

#### Challenges:

- ▶ Pathogen exposure
- ▶ Challenges with isolation compliance

### Specialty Areas/Occasions

Physical/Occupational Therapy, Laundry Rooms, Bio Spills

In one study, over 90% of high-touch surfaces in long-term care facilities tested positive for pathogen contamination.<sup>4</sup>

#### Challenges:

- ▶ Lots of shared equipment and surfaces
- ▶ Strong odors and stains
- ▶ Many soft surfaces

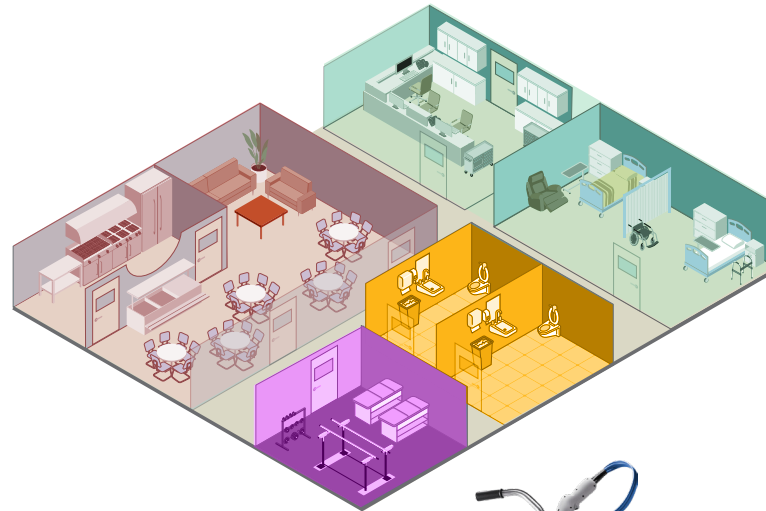

### Medium Risk Areas/Occasions

Resident Rooms, Equipment, Nursing Stations

Data from 2009–2018 found that 61% of Norovirus outbreaks occur in long-term care facilities (LTCFs).<sup>2</sup> Outbreaks in LTCFs resulted in costs of \$150-165 million, annually.<sup>3</sup>

#### Challenges:

- ▶ Many types of high-touch surfaces and equipment, including personal furniture and items
- ▶ Regularly soiled/stained surfaces
- ▶ Shared rooms

### Large/Public Areas

Public Restrooms, Entry Ways, Shower Rooms

88% of surveyed Americans agree that they would have a negative view of a skilled nursing facility or long-term care facility if it is not clean.<sup>5</sup>

#### Challenges:

- ▶ Lots of areas to cover quickly
- ▶ High traffic from residents, staff and visitors
- ▶ Variety of hard and soft surfaces requiring cleaning and disinfection

1. McKinnell, J., Miller, L., Singh, R., et al. High Prevalence of Multi-drug-Resistant Organism Colonization in 28 Nursing Homes: An "Iceberg Effect," Journal of the American Medical Directors Association, Volume 21, Issue 12, 2020, 1937-1943.e2.  
 2. Calderwood, L., Wikswo, M., Mattison, C., Kambhampati, et al., Norovirus Outbreaks in Long-term Care Facilities in the United States, 2009–2018: A Decade of Surveillance, Clinical Infectious Diseases, Volume 74, Issue 1, 1 January 2022, Pages 113–119, <https://doi.org/10.1093/cid/ciab808>  
 3. Bartsch, Sarah M et al. "The Clinical and Economic Burden of Norovirus Gastroenteritis in the United States." The Journal of Infectious Diseases vol. 222,11 (2020): 1910-1919. doi:10.1093/infdis/jiaa292  
 4. Cannon, J., Park, G., Anderson, B., et al., Hygienic monitoring in long-term care facilities using ATP, crAssphage, and human noroviruses to direct environmental surface cleaning, American Journal of Infection Control, Volume 50, Issue 3, 2022, Pages 289-294  
 5. Clorox Professional Products Company and Ketchum. (2018 August). Clorox Custom Research Survey of 1,000 American adults 18 years or older.

|                             | Products   | When  | Where   | Who                            | How Often   |
|-----------------------------|--|---|---|--------------------------------|---|
| High Risk Areas/Occasions   | <b>Clorox Healthcare® Fuzion® Cleaner Disinfectant</b><br>31478 Spray, 9/32 fl. oz.   | During the day, as needed;<br>at the end of the day                               | High risk spaces, Isolation rooms, bathrooms, high touch surfaces     | Cleaning staff, Clinical staff | When <i>C. diff</i> or <i>C. auris</i> is identified, during outbreaks, or when conducting turnover clean |
|                             | <b>Clorox Healthcare® Bleach Germicidal Disinfectants</b><br>35309 Wipes, 6.75" x 9", 6/70 ct.<br>30577 Wipes, 6"x5", 6/150 ct.<br>31424 Wipes, 6.75"x9", 6/50 ct. carton<br>68970 Spray, 86/32 fl. oz.<br>68832 Pull-Top bottle, 9/32 fl. oz.  68978 Refill, 4/128 fl. oz.   |   |   |                                |   |
| Medium Risk Areas/Occasions | <b>Clorox Healthcare® Hydrogen Peroxide Cleaner Disinfectants</b><br>30828 Spray, 9/32 fl. oz.<br>30829 Refill, 4/128 fl. oz.<br>30824 Wipes, 6.75" x 9", 6/95 ct.<br>30825 Wipes, 6.75" x 5.75", 6/155 ct.   | Daily cleaning and disinfection, and after each use (equipment)                   | Soft or hard surfaces in medium risk or specialty areas               | Clinical staff, Cleaning staff | Daily, In between uses or after high-use periods  |
|                             | <b>Clorox® Disinfecting Wipes</b><br>15949 75 ct. Fresh Scent   |   |   |                                |   |
| Specialty Areas             | <b>CloroxPro® Clorox® Disinfecting Bio Stain &amp; Odor Remover</b><br>31903 Spray, 32 fl. oz.<br>31911 Pull-Top Bottle, 32 fl. oz.<br>31910 Refill, 128 fl. oz.    | When there is blood, body fluids or bad odors present (e.g., feces, vomit, urine) | Places where bio spills happen, or where odor tends to be a challenge | Clinical staff, Cleaning staff | As necessary  |
|                             | <b>CloroxPro® Clorox® Urine Remover</b><br>31036 Spray, 32 fl. oz.<br>31415 Pull-Top Bottle, 32 fl. oz.   | When there is urine odor or stain challenges                                      | Laundry pre-treatment, soft surfaces, bathrooms                       | Cleaning staff                 | As necessary  |
|                             | <b>Clorox Healthcare® Citrace® Hospital Disinfectant &amp; Sanitizer</b><br>49100 14 oz. can   |   |   |                                |   |
| Large/Public Areas          | <b>Electrostatic Sprayers and Chemistries</b><br>60025 Total 360° Electrostatic Sprayer, 1/1 ct. <br>29561 Clorox® TurboPro® Electrostatic Sprayer, 2/1 ct. <br>Clorox® offers several disinfectants with EPA approval to be used through electrostatic devices. | Daily cleaning and disinfection   | Large and public areas  | Cleaning Staff                 | Daily, at the end of the day or when no residents or other staff are present                              |

